

1515N5M | 贵金属电刷 Precious Metal Commutation

应用领域：医疗、保健、汽车、机器人、工业自动化等精密驱动领域。

Applications: precision drives in medical equipment and devices, healthcare products, automotive, robotics, and industrial automation.

主要技术指标 | Characteristics

			02-255-7.4	10-240-12.0	07-220-18.0	
1	电压	Voltage	V	7.4	12.0	18.0
2	端电阻	Terminal resistance	Ω	2.5	8.1	30.8
3	空载转速	No-load speed	rpm	25500	24000	22000
4	空载电流	No-load current	mA	95	50	15
5	堵转转矩	Stall torque	mNm	7.7	6.6	4.3
6	堵转电流	Stall current	mA	2960	1480	580
7	额定转矩	Nominal torque	mNm	2.0	1.5	1.0
8	额定转速	Nominal speed	rpm	18860	18540	16890
9	额定电流	Nominal current	mA	840	380	150
10	最大输出功率	Max. output power	W	5.14	4.15	2.48
11	最大效率	Max. efficiency	%	67	67	71
12	反电势常数	Back-EMF constant	mV/rpm	0.3	0.5	0.8
13	转矩常数	Torque constant	mNm/A	2.7	4.6	7.6
14	转速 / 转矩斜率	Speed/torque gradient	rpm/mNm	3320	3640	5110
15	转子惯量	Rotor inertia	gcm ²	0.21	0.21	0.21
16	重量	Weight	g	14.2	14.2	14.2
17	热阻 (机壳 - 环境)	Thermal resistance housing-ambient	K/W		32.1	
18	热阻 (线圈 - 机壳)	Thermal resistance winding-housing	K/W		26.3	
19	热时常数 (电机)	Thermal time constant motor	s		130	
20	热时常数 (线圈)	Thermal time constant winding	s		98	
21	工作温度范围	Operating temperature range	°C		-20~+85	
22	绕组耐温等级	Thermal class of winding	°C		130	
23	轴向间隙	Axial play	mm		≤0.3	
24	径向间隙	Radial play	mm		0.012	
25	动态轴向载荷	Axial load dynamic	N		0.15	
26	静态轴向载荷	Axial load static	N		15	
27	径向载荷 (距安装面 3mm)	Radial load at 3 mm from mounting face	N		0.4	
28	极对数	No. of pole pairs			1	
29	轴承	Bearings			2 枚含油轴承/2 sleeve bearings	
30	换向结构	Commutator			贵金属 5 相/metal 5 segments	
31	防护等级	Protection class			IP 30	

★可选参数 Options: 导线长度 Lead wires length 轴长 Shaft length 性能 Special coils

齿轮箱 Gearheads

外观图 | Outline Drawing

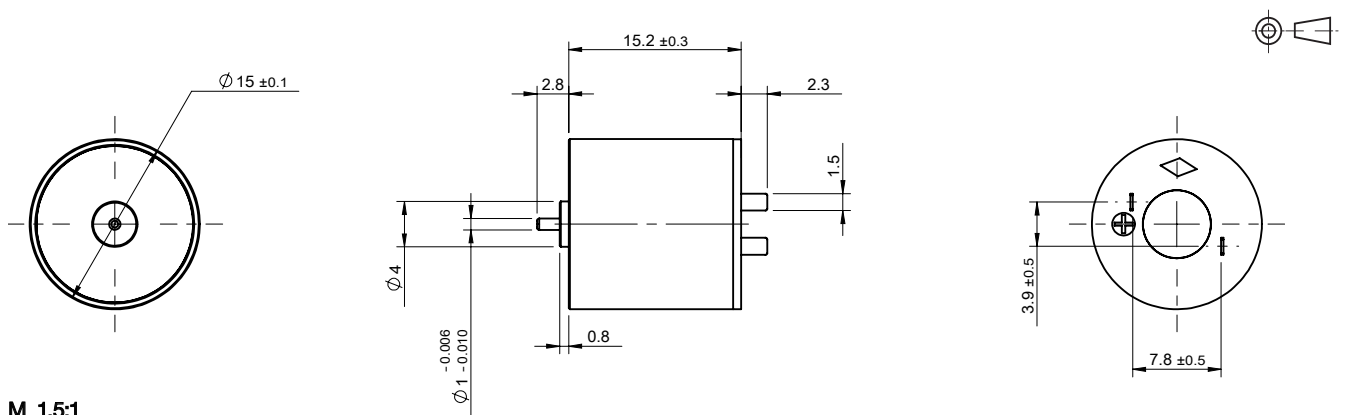

M 1.5:1