

1630N5M | 贵金属电刷 Precious Metal Commutation

应用领域：医疗、保健、汽车、机器人、工业自动化等精密驱动领域。

Applications: precision drives in medical equipment and devices, healthcare products, automotive, robotics, and industrial automation.

主要技术指标 | Characteristics

			22-116-5.0	29-78-7.4	36-87-12.0
1	电压	Voltage	V	5.0	12.0
2	端电阻	Terminal resistance	Ω	1.5	9.4
3	空载转速	No-load speed	rpm	11600	8700
4	空载电流	No-load current	mA	36	7
5	堵转转矩	Stall torque	mNm	13.4	16.7
6	堵转电流	Stall current	mA	3330	1280
7	额定转矩	Nominal torque	mNm	3.0	4.0
8	额定转速	Nominal speed	rpm	9010	6610
9	额定电流	Nominal current	mA	770	310
10	最大输出功率	Max. output power	W	4.1	3.8
11	最大效率	Max. efficiency	%	80	86
12	反电势常数	Back-EMF constant	mV/rpm	0.4	1.4
13	转矩常数	Torque constant	mNm/A	4.1	13.1
14	转速 / 转矩斜率	Speed/torque gradient	rpm/mNm	860	520
15	转子惯量	Rotor inertia	gcm ²	0.6	0.7
16	重量	Weight	g	27	27
17	热阻 (机壳 - 环境)	Thermal resistance housing-ambient	K/W		26.79
18	热阻 (线圈 - 机壳)	Thermal resistance winding-housing	K/W		3.79
19	热时常数 (电机)	Thermal time constant motor	s		242
20	热时常数 (线圈)	Thermal time constant winding	s		232
21	工作温度范围	Operating temperature range	°C		-20~+85
22	绕组耐温等级	Thermal class of winding	°C		130
23	轴向间隙	Axial play	mm		0.02~0.15
24	径向间隙	Radial play	mm		0.025
25	动态轴向载荷	Axial load dynamic	N		2.2
26	静态轴向载荷	Axial load static	N		30
27	径向载荷 (距安装面 3mm)	Radial load at 3 mm from mounting face	N		8
28	极对数	No. of pole pairs			1
29	轴承	Bearings		2 枚含油轴承/2 sleeve bearings	
30	换向结构	Commutator		贵金属 5 相/metal 5 segments	
31	防护等级	Protection class		IP 30	

★可选参数 Options: 导线长度 Lead wires length 轴长 Shaft length 性能 Special coils

轴承类型 Bearing type 齿轮箱 Gearheads

外观图 | Outline Drawing

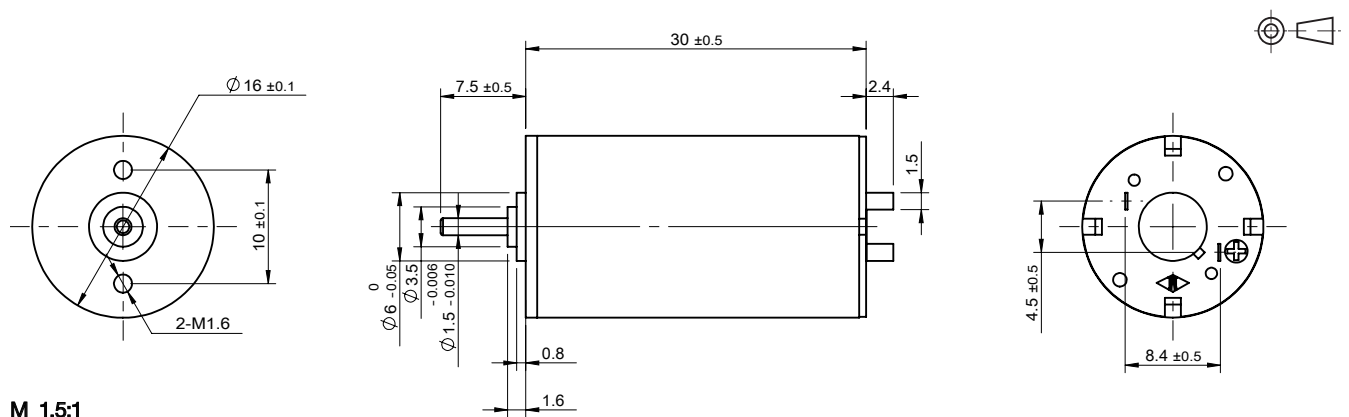

M 1.5:1