

B0815N2B | 内转子无槽无传感器 Inner Rotor, Slotless, Sensorless

应用领域：医疗器械、工业设备等精密驱动领域。

Applications: precision drives in medical equipment, industrial automation fields.

主要技术指标 | Characteristics

			02-81-3.7	04-200-5.0	05-323-3.7	
1	电压	Voltage	V	3.7	5.0	3.7
2	端电阻	Terminal resistance	Ω	36.5	11.8	3.1
3	空载转速	No-load speed	rpm	8100	20000	32300
4	空载电流	No-load current	A	0.02	0.05	0.1
5	堵转转矩	Stall torque	mNm	0.32	0.79	1.1
6	堵转电流	Stall current	A	0.1	0.42	1.2
7	额定转矩	Nominal torque	mNm	0.1	0.2	0.2
8	额定转速	Nominal speed	rpm	6800	16100	27800
9	额定电流	Nominal current	A	0.03	0.13	0.26
10	最大输出功率	Max. output power	W	0.07	0.4	0.92
11	最大效率	Max. efficiency	%	38	43.0	50
12	反电势常数	Back-EMF constant	mV/rpm	0.39	0.22	0.10
13	转矩常数	Torque constant	mNm/A	3.70	2.10	1.00
14	KV 值	KV Value	rpm/V	2180	4000	8730
15	转速 / 转矩斜率	Speed/torque gradient	rpm/mNm	25310	25310	29360
16	转子惯量	Rotor inertia	gcm ²	0.02	0.02	0.02
17	重量	Weight	g	3	3	3
18	热阻 (机壳 - 环境)	Thermal resistance housing-ambient	K/W		110	
19	热阻 (线圈 - 机壳)	Thermal resistance winding-housing	K/W		26	
20	热时常数 (电机)	Thermal time constant motor	s		63	
21	热时常数 (线圈)	Thermal time constant winding	s		57	
22	工作温度范围	Operating temperature range	°C		-40~+100	
23	绕组耐温等级	Thermal class of winding	°C		130	
24	轴向间隙	Axial play	mm		0.012	
25	径向间隙	Radial play	mm		0.008	
26	动态轴向载荷	Axial load dynamic	N		1	
27	静态轴向载荷	Axial load static	N		25	
28	径向载荷 (距安装面 3mm)	Radial load at 3 mm from mounting face	N		6.3	
29	极对数	No. of pole pairs			1	
30	轴承	Bearings			2 枚滚动轴承/2 ball bearings	
31	换向结构	Commutation			无传感器/Sensorless	
32	防护等级	Protection class			IP 20	

★可选参数 Options: 导线长度 Lead wires length 轴长 Shaft length 性能 Special coils 齿轮箱 Gearheads 轴承类型 Bearing type 霍尔传感器 Hall sensor

编码器 Encoder 驱动器 Driver

外观图 | Outline Drawing

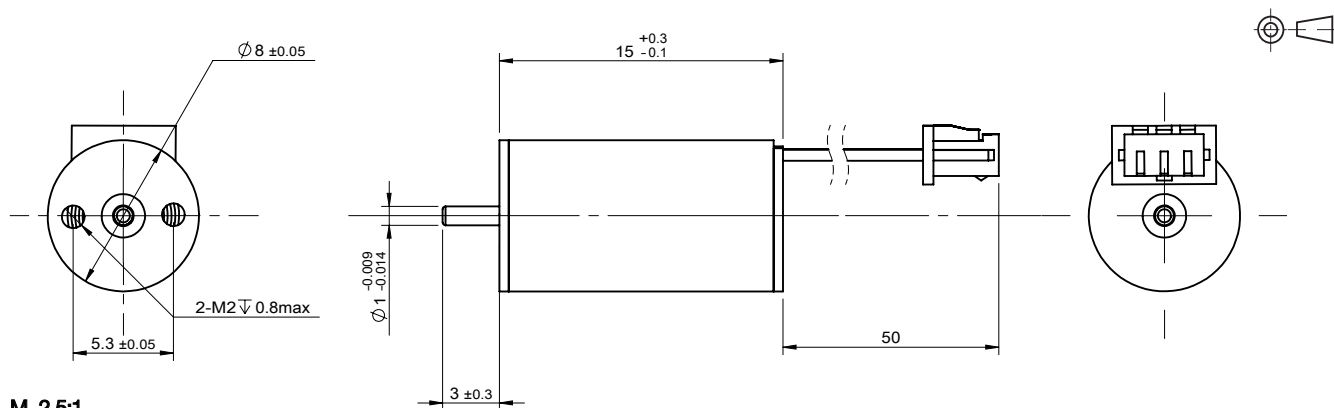

M 2.5:1