

2433N5M2B | 贵金属电刷 Precious Metal Commutation

应用领域：医疗、保健、汽车、机器人、工业自动化等精密驱动领域。

Applications: precision drives in medical equipment and devices, healthcare products, automotive, robotics, and industrial automation.

主要技术指标 | Characteristics

			01-78-4.5	** -80-9.0	** -80-24.0	
1	电压	Voltage	V	4.5	9.0	24.0
2	端电阻	Terminal resistance	Ω	0.5	2.0	16.0
3	空载转速	No-load speed	rpm	8000	8000	8000
4	空载电流	No-load current	mA	35	30	15
5	堵转转矩	Stall torque	mNm	48.0	47.7	42.1
6	堵转电流	Stall current	mA	9000	4500	1500
7	额定转矩	Nominal torque	mNm	3.0	2.5	5.0
8	额定转速	Nominal speed	rpm	7500	7580	7050
9	额定电流	Nominal current	mA	600	260	190
10	最大输出功率	Max. output power	W	10.1	10.0	8.8
11	最大效率	Max. efficiency	%	88	84	81
12	反电势常数	Back-EMF constant	mV/rpm	0.6	1.1	3.0
13	转矩常数	Torque constant	mNm/A	5.4	10.7	28.4
14	转速 / 转矩斜率	Speed/torque gradient	rpm/mNm	170	170	190
15	转子惯量	Rotor inertia	gcm ²	2.2	2.2	2.2
16	重量	Weight	g	68	68	68
17	热阻 (机壳 - 环境)	Thermal resistance housing-ambient	K/W		16.8	
18	热阻 (线圈 - 机壳)	Thermal resistance winding-housing	K/W		22.1	
19	热时常数 (电机)	Thermal time constant motor	s		332	
20	热时常数 (线圈)	Thermal time constant winding	s		263	
21	工作温度范围	Operating temperature range	°C		-20~+85	
22	绕组耐温等级	Thermal class of winding	°C		130	
23	轴向间隙	Axial play	mm		0.01~0.15	
24	径向间隙	Radial play	mm		0.025	
25	动态轴向载荷	Axial load dynamic	N		3.3	
26	静态轴向载荷	Axial load static	N		60	
27	径向载荷 (距安装面 3mm)	Radial load at 3 mm from mounting face	N		14	
28	极对数	No. of pole pairs			1	
29	轴承	Bearings			2 枚滚动轴承/2 ball bearings	
30	换向结构	Commutator			贵金属 5 相/metal 5 segments	
31	防护等级	Protection class			IP 20	

★可选参数 Options: 导线长度 Lead wires length 轴长 Shaft length 性能 Special coils

齿轮箱 Gearheads 编码器 Encoder

外观图 | Outline Drawing

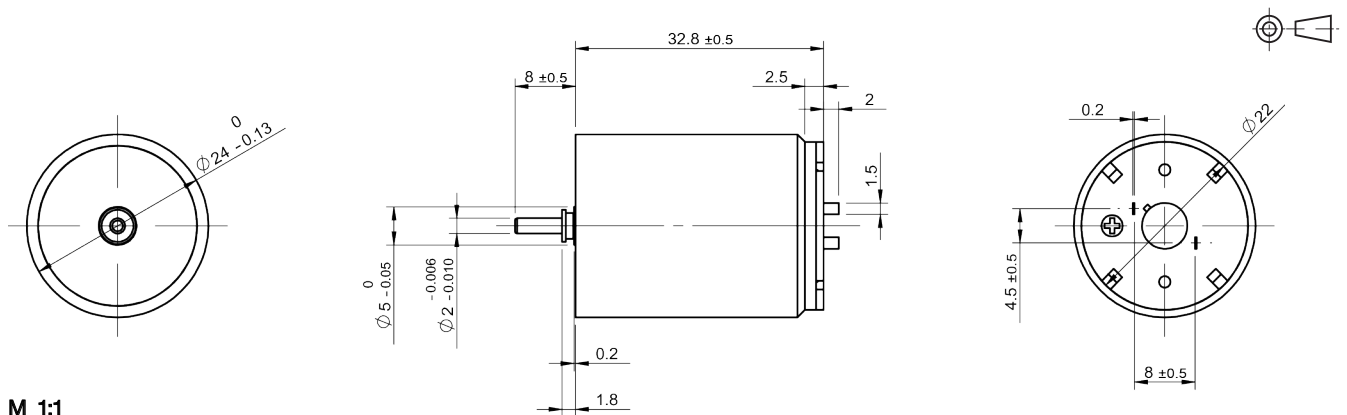

M 1:1